

# Connector EMI Suppression Plates

To reduce conducted EMI, "D" type and other types of suppression plates are available in several sizes and pin layouts.

- Impedance specification applies to all holes. They are tested for impedance with a single turn, using a Hewlett Packard HP 4193A Vector Impedance Meter.
- For impedance vs. frequency curves for these parts, please see Figures 7-21.
- For any connector EMI suppression plate requirement not listed in the catalog, feel free to contact our customer service group for availability and pricing.
- The Expanded Cable and Connector EMI Suppressor Kit (part number 0199000005) and the Connector EMI Suppression Plate Kit (0199000020) contain a selection of these cores. See page 92.

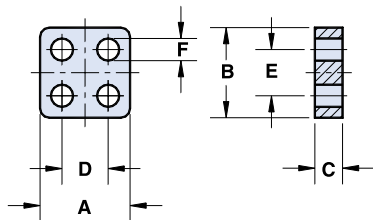

Figure 1

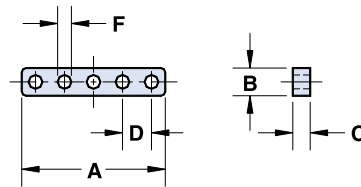

Figure 2

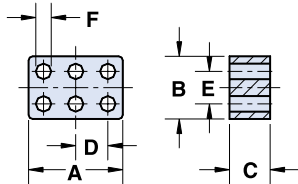

Figure 3

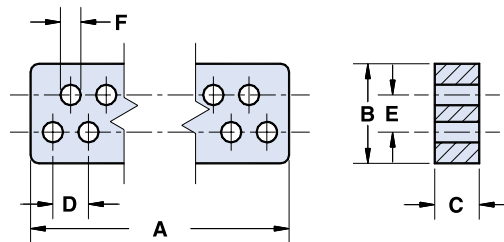

Figure 4

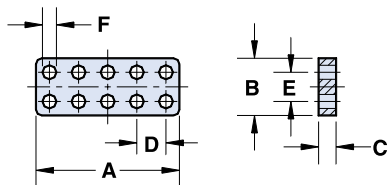

Figure 5

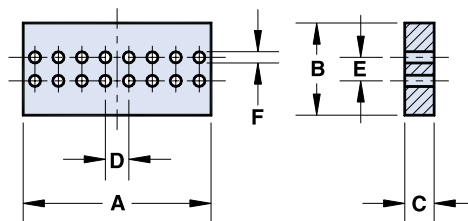

Figure 6

# Connector EMI Suppression Plates

Dimensions (Bold numbers are in millimeters, light numbers are nominal in inches.)

Typical Impedance( $\Omega$ )<sup>1</sup>

Part Number**	Figure	Number of Holes	Number of Rows	A	B	C*	D	E	F	Wt (g)	25 MHz	100 MHz	Z, R <sub>s</sub> , X <sub>i</sub> vs. Frequency Curve
2644246001	1	4	2	<b>3.86±0.10</b> .152	<b>3.86±0.10</b> .152	<b>1.52±0.13</b> .060	<b>2.00±0.08</b> .079	<b>2.00±0.08</b> .079	<b>0.82±0.1</b> .034	.10	14	28	Figure 7
2644246101	1	4	2	<b>3.86±0.10</b> .152	<b>3.86±0.10</b> .152	<b>6.35±0.13</b> .250	<b>2.00±0.08</b> .079	<b>2.00±0.08</b> .079	<b>0.82±0.1</b> .034	.38	46	73	Figure 8
2644245901	1	4	2	<b>4.90±0.10</b> .193	<b>4.90±0.10</b> .193	<b>1.52±0.13</b> .060	<b>2.54±0.13</b> .100	<b>2.54±0.10</b> .100	<b>1.22±0.07</b> .048	.15	13	28	Figure 9
2644245601	1	4	2	<b>4.90±0.10</b> .193	<b>4.90±0.10</b> .193	<b>6.35±0.13</b> .250	<b>2.54±0.13</b> .100	<b>2.54±0.10</b> .100	<b>1.22±0.07</b> .048	.60	41	66	Figure 10
2644246701	2	5	1	<b>12.52±0.13</b> .493	<b>2.54 Max.</b> .100 Max.	<b>1.52±0.13</b> .060	<b>2.54±0.13</b> .100	—	<b>1.22±0.07</b> .048	.18	13	28	Figure 9
2644246801	2	5	1	<b>12.52±0.13</b> .493	<b>2.54 Max.</b> .100 Max.	<b>3.05±0.13</b> .120	<b>2.54±0.13</b> .100	—	<b>1.22±0.07</b> .048	.35	20	36	Figure 11
2644246901	2	5	1	<b>12.52±0.13</b> .493	<b>2.54 Max.</b> .100 Max.	<b>6.10±0.13</b> .240	<b>2.54±0.13</b> .100	—	<b>1.22±0.07</b> .048	.70	38	59	Figure 12
2644246201	3	6	2	<b>5.86±0.10</b> .231	<b>3.86±0.10</b> .152	<b>1.52±0.13</b> .060	<b>2.00±0.08</b> .079	<b>2.00±0.08</b> .079	<b>0.82±0.1</b> .034	.14	14	28	Figure 7
2644246301	3	6	2	<b>5.86±0.10</b> .231	<b>3.86±0.10</b> .152	<b>6.35±0.13</b> .250	<b>2.00±0.08</b> .079	<b>2.00±0.08</b> .079	<b>0.82±0.1</b> .034	.60	46	73	Figure 8
2644245701	3	6	2	<b>7.44±0.10</b> .293	<b>4.90±0.10</b> .193	<b>1.52±0.13</b> .060	<b>2.54±0.13</b> .100	<b>2.54±0.10</b> .100	<b>1.22±0.07</b> .048	.22	13	28	Figure 9
2644245801	3	6	2	<b>7.44±0.10</b> .293	<b>4.90±0.10</b> .193	<b>6.35±0.13</b> .250	<b>2.54±0.13</b> .100	<b>2.54±0.10</b> .100	<b>1.22±0.07</b> .048	.94	41	66	Figure 10
2644236101	4	9	2	<b>14.40±0.15</b> .567	<b>7.75-0.25</b> .300	<b>3.43±0.13</b> .135	<b>2.75±0.13</b> .108	<b>2.85±0.13</b> .112	<b>1.60±0.08</b> .062	1.6	30	51	Figure 13
2644236401	4	9	2	<b>14.40±0.15</b> .567	<b>7.75-0.25</b> .300	<b>6.86±0.13</b> .270	<b>2.75±0.13</b> .108	<b>2.85±0.13</b> .112	<b>1.60±0.08</b> .062	3.2	56	91	Figure 14
2644247301	5	10	2	<b>6.22±0.10</b> .245	<b>3.30±0.10</b> .130	<b>1.52±0.13</b> .060	<b>1.27±0.10</b> .050	<b>1.27±0.08</b> .050	<b>0.69±0.05</b> .027	.08	13	28	Figure 15
2644247401	5	10	2	<b>6.22±0.10</b> .245	<b>3.30±0.10</b> .130	<b>3.05±0.13</b> .120	<b>1.27±0.10</b> .050	<b>1.27±0.08</b> .050	<b>0.69±0.05</b> .027	.17	24	41	Figure 16
2644247501	5	10	2	<b>6.22±0.10</b> .245	<b>3.30±0.10</b> .130	<b>6.10±0.13</b> .240	<b>1.27±0.10</b> .050	<b>1.27±0.08</b> .050	<b>0.69±0.05</b> .027	.34	41	65	Figure 17
2644247001	5	10	2	<b>12.52±0.13</b> .493	<b>4.90±0.10</b> .193	<b>1.52±0.13</b> .060	<b>2.54±0.13</b> .100	<b>2.54±0.10</b> .100	<b>1.22±0.07</b> .048	.37	13	28	Figure 9
2644247101	5	10	2	<b>12.52±0.13</b> .493	<b>4.90±0.10</b> .193	<b>3.05±0.13</b> .120	<b>2.54±0.13</b> .100	<b>2.54±0.10</b> .100	<b>1.22±0.07</b> .048	.74	23	40	Figure 18
2644247201	5	10	2	<b>12.52±0.13</b> .493	<b>4.90±0.10</b> .193	<b>6.10±0.13</b> .240	<b>2.54±0.13</b> .100	<b>2.54±0.10</b> .100	<b>1.22±0.07</b> .048	1.5	40	64	Figure 19
2644236301	4	15	2	<b>22.55±0.25</b> .888	<b>7.75-0.25</b> .300	<b>3.43±0.13</b> .135	<b>2.75±0.13</b> .108	<b>2.85±0.13</b> .112	<b>1.60±0.08</b> .062	2.4	30	51	Figure 13
2644236501	4	15	2	<b>22.55±0.25</b> .888	<b>7.75-0.25</b> .300	<b>6.86±0.13</b> .270	<b>2.75±0.13</b> .108	<b>2.85±0.13</b> .112	<b>1.60±0.08</b> .062	4.9	56	91	Figure 14
2644373941	6	16	2	<b>21.60±0.25</b> .850	<b>11.65-0.40</b> .451	<b>1.52±0.13</b> .060	<b>2.54±0.13</b> .100	<b>7.62±0.15</b> .300	<b>1.00±0.15</b> .042	2.9	19	36	Figure 20
2644373841	6	16	2	<b>20.30±0.25</b> .800	<b>10.15-0.40</b> .392	<b>3.18±0.13</b> .125	<b>2.54±0.13</b> .100	<b>2.54±0.10</b> .100	<b>1.22±0.07</b> .048	2.8	30	51	Figure 21
2644236001	4	25	2	<b>36.3±0.4</b> 1.430	<b>7.75-0.25</b> .300	<b>3.43±0.13</b> .135	<b>2.75±0.13</b> .108	<b>2.85±0.13</b> .112	<b>1.60±0.08</b> .062	3.6	30	51	Figure 13
2644236601	4	25	2	<b>36.3±0.4</b> 1.430	<b>7.75-0.25</b> .300	<b>6.86±0.13</b> .270	<b>2.75±0.13</b> .108	<b>2.85±0.13</b> .112	<b>1.60±0.08</b> .062	7.2	56	91	Figure 14
2644251801	4	37	2	<b>52.8±0.7</b> 2.079	<b>7.75-0.25</b> .300	<b>3.43±0.13</b> .135	<b>2.75±0.13</b> .108	<b>2.85±0.13</b> .112	<b>1.60±0.08</b> .062	5.4	30	51	Figure 13
2644251901	4	37	2	<b>52.8±0.7</b> 2.079	<b>7.75-0.25</b> .300	<b>6.86±0.13</b> .270	<b>2.75±0.13</b> .108	<b>2.85±0.13</b> .112	<b>1.60±0.08</b> .062	11	56	91	Figure 14

\* This dimension may be modified to suit specific applications.

\*\* Bold part numbers designate preferred parts.

<sup>1</sup> Guaranteed Z Min is Z Typ -20%

P.O. Box J, One Commercial Row, Wallkill, NY 12589-0288

Fair-Rite Products Corp.

Phone: (888) FAIR RITE / (845) 895-2055 • FAX: (888) FERRITE / (845) 895-2629 • www.fair-rite.com • E-Mail: ferrites@fair-rite.com  
(888) 324-7748 (888) 337-7483 Note: (914) Area Code has changed to (845).